



ATH-TWX7

Wireless Headphones

User Manual

English

Safety precautions

Although this product was designed to be used safely, failing to use it correctly may result in an accident. To ensure safety, observe all warnings and cautions while using the product.

Cautions for the headphones

- Do not use the product near medical equipment. Radio waves may affect cardiac pacemakers and medical electronic equipment. Do not use the product inside medical facilities.
- When using the product in aircraft, follow airline instructions.
- Do not use the product near automatic control devices such as automatic doors and fire alarms. Radio waves may affect electronic equipment and cause accidents due to malfunction.
- Do not disassemble, modify or attempt to repair the product to avoid electric shock, malfunction or fire.
- Do not subject the product to strong impact to avoid electric shock, malfunction or fire.
- Do not handle the product with wet hands to avoid electric shock or injury.
- Disconnect the product from a device if the product begins to malfunction, producing smoke, odor, heat, unwanted noise or showing other signs of damage. In such a case, contact your local Audio-Technica dealer.
- Do not allow the product to get wet to avoid electric shock or malfunction.
- Do not put foreign matter such as combustible materials, metal, or liquid in the product.
- Do not cover the product with a cloth to avoid fire or injury by overheating.
- Follow applicable laws regarding mobile phone and headphone use if using headphones while driving.
- Do not use the product in places where the inability to hear ambient sound presents a serious risk (such as at railroad crossings, train stations, and construction sites).
- The product effectively shields external sound, so you may not hear sound around you clearly while wearing the product. Adjust the volume to a level where you can still hear background sound and monitor the area around you while listening to music.
- Store the product out of the reach of small children.
- To prevent damage to your hearing, do not raise the volume too high. Listening to loud sound for an extended period may cause temporary or permanent hearing loss.
- Discontinue use if skin irritation results from direct contact with the product.
- If you begin to feel unwell while using the product, discontinue use immediately.
- When removing the product from your ears, check to make sure the eartips are still attached to the main unit. If the eartips become lodged in your ears and you are unable to remove them, consult a physician at once.
- If you develop an itch from wearing the product, discontinue use.

Cautions for charging case

- Do not disassemble, modify or attempt to repair the product to avoid electric shock, malfunction or fire.
- Do not subject the product to strong impact to avoid electric shock, malfunction or fire.
- Do not handle the product with wet hands to avoid electric shock or injury.
- Disconnect the product from a device if the product begins to malfunction, producing smoke, odor, heat, unwanted noise or showing other signs of damage. In such a case, contact your local Audio-Technica dealer.
- Do not allow the product to get wet to avoid electric shock or malfunction.
- Do not put foreign matter such as combustible materials, metal, or liquid in the product.

Safety precautions

- Do not cover the product with a cloth to avoid fire or injury by overheating.
- Do not charge the battery if the terminal of the USB charging cable is bent, loose, or damaged. Doing so may cause heat generation, smoke emission, fire or electric shock.
- Do not charge the product if water or foreign matter is inside the battery jack or USB charging cable. Doing so may cause corrosion, heat generation, smoke, fire, or other malfunction or electric shock in the battery jack or USB charging cable.
- When charging, make sure to use the included USB charging cable.
- Do not charge with devices that have quick-charge functionality (with a voltage of 5 V or more). Doing so may cause the product to malfunction.
- Do not store the product in direct sunlight, near heating devices, or in hot, humid, or dusty places because such storage could cause malfunction or defect.
- Do not put the product close to fire because that could cause deformation or malfunction.
- Do not use benzine, paint thinners and electrical contact cleaner, etc. because use of such material could cause deformation or malfunction.

Cautions for rechargeable battery

The headphones and charging case are equipped with a rechargeable battery (lithium-ion battery).

- If battery fluid gets into eyes, do not rub them. Rinse thoroughly with clean water such as tap water and consult a doctor immediately.
- If battery fluid leaks, do not touch fluid with bare hands. If fluid remains inside the product, it may cause malfunction. If battery fluid leaks, contact your local Audio-Technica dealer.
 - If fluid gets in your mouth, gargle thoroughly with clean water such as tap water and consult a doctor immediately.
 - If your skin or clothing comes in contact with fluid, immediately wash the affected skin or clothing with water. If you experience skin irritation, consult a doctor.
- To avoid leakage, generation of heat or explosion:
 - Never heat, disassemble or modify the battery, nor dispose of it in a fire.
 - Do not attempt to pierce with a nail, hit with a hammer or step on the battery.
 - Do not drop the product or subject it to strong impact.
 - Do not get the battery wet.
- Do not use, leave or store the battery in the following places:
 - Area exposed to direct sunlight or high temperatures and humidity
 - Inside of a car under the blazing sun
 - Near heat sources such as heat registers
- Charge only with the included USB cable to avoid malfunction or fire.
- The internal rechargeable battery of this product cannot be replaced by the user. The battery may have reached the end of its service life if the usage time becomes significantly shorter even after the battery has been fully charged. If this is the case, the battery needs to be repaired. Contact your local Audio-Technica dealer for repair details.
- When the product is disposed of, the built-in rechargeable battery needs to be discarded properly. Contact your local Audio-Technica dealer to learn how to properly dispose of the battery.

For customers in the USA

FCC Notice

Warning

This device complies with Part 15 of the FCC Rules. Operation is subject to the following two conditions: (1) This device may not cause harmful interference, and (2) this device must accept any interference received, including interference that may cause undesired operation.

Caution

You are cautioned that any changes or modifications not expressly approved in this manual could void your authority to operate this equipment.

Note: This equipment has been tested and found to comply with the limits for a Class B digital device, pursuant to part 15 of the FCC Rules. These limits are designed to provide reasonable protection against harmful interference in a residential installation. This equipment generates, uses and can radiate radio frequency energy and, if not installed and used in accordance with the instructions, may cause harmful interference to radio communications. However, there is no guarantee that interference will not occur in a particular installation. If this equipment does cause harmful interference to radio or television reception, which can be determined by turning the equipment off and on, the user is encouraged to try to correct the interference by one or more of the following measures:

- Reorient or relocate the receiving antenna.
- Increase the separation between the equipment and receiver.
- Connect the equipment to an outlet on a circuit different from that to which the receiver is connected.
- Consult the dealer or an experienced radio/TV technician for help.

This transmitter must not be co-located or operated in conjunction with any other antenna or transmitter used in other systems.

RF Exposure Statement

This device meets the government's requirements for exposure to radio waves. This device is designed and manufactured not to exceed the emission limits for exposure to radio frequency (RF) energy set by the Federal Communications Commission of the U.S. Government. The exposure standard for wireless device employs a unit of measurement known as the Specific Absorption Rate, or SAR. The SAR limit set by the FCC is 1.6 W/kg.

Contact

Responsible Company: Audio-Technica U.S., Inc.
Address: 1221 Commerce Drive, Stow, Ohio 44224, USA
Tel: 330-686-2600

For customers in Canada

ISED statement

CAN ICES-003(B)/NMB-003(B)

This device contains licence-exempt transmitter(s)/receiver(s) that comply with Innovation, Science and Economic Development Canada's licence-exempt RSS(s). Operation is subject to the following two conditions:

Safety precautions

(1) This device may not cause interference.

(2) This device must accept any interference, including interference that may cause undesired operation of the device.

This device complies with RSS-102 radiation exposure limits set forth for an uncontrolled environment.

Notes on use

- Be sure to read the connected device's user manual before use.
- Audio-Technica will not be liable in any way for any loss of data in the unlikely event that such losses should occur while using the product.
- On public transportation or in other public places, keep the volume low so as not to disturb other people.
- Minimize the volume on your device before connecting the product.
- When using the product in a dry environment, you may feel a tingling sensation in your ears. This is caused by static electricity accumulated on your body, not by product malfunction.
- Do not subject the product to strong impact.
- Do not store the product in direct sunlight, near heating devices, or in hot, humid, or dusty places. Additionally, do not allow the product to get wet.
- When the product is used for a long time, the product may become discolored due to ultraviolet light (especially direct sunlight) and wear.
- If the charging case is placed in a bag while the USB charging cable is still connected, the USB charging cable may become caught, severed, or broken.
- Make sure to hold the plug when connecting and disconnecting the USB charging cable. The USB charging cable may become severed or an accident may occur if you pull on the cable itself.
- When you are not using the USB charging cable, disconnect it from the charging case.
- When you are not using the product, store it in the included charging case.
- If you use eartips other than those included, the headphones may not fit into the charging case, or may not charge. Be sure to use the included eartips.
- When using the product, select the eartips that fit your ears best, and wear the product securely.
- This product can be used to talk on the phone only when using a mobile telephone network. Support for telephony apps that use a mobile data network is not guaranteed.
- If you use the product near an electronic device or transmitter (such as a mobile phone), unwanted noise may be heard. In this case, move the product away from the electronic device or transmitter.
- If you use the product near a radio antenna, noise may be seen or heard in the radio signal. In this case, move the product away from the radio antenna.
- To protect the built-in rechargeable battery, charge it at least once every 6 months. If too much time passes between charges, the life of the rechargeable battery may be reduced, or the rechargeable battery may no longer be able to be charged.
- Charge the product in a well-ventilated place (10 to 35°C (50 to 95°F)) away from direct sunlight. Otherwise, the battery may deteriorate, possibly resulting in shorter periods of continuous use or may fail to charge.
- If the headphones are wet, wipe them with a dry cloth before placing them in the charging case. The charging case is not water-resistant (drip-proof). Do not charge the product if the headphones are wet.
- The talk-through mode or hear-through mode of the product allows you to hear the sounds around you through the built-in microphone. Depending on the volume of the music being played back, the surrounding sounds may be difficult to hear.
- Depending on your surroundings, the ambient sounds may be difficult to hear even when using the product's talk-through mode or hear-through mode. Do not use the product in places that are dangerous if you cannot hear the surrounding sounds, such as places with heavy traffic.
- Operate the touch sensor with one finger. Operating with a sharp-tipped object, such as a ballpoint pen or pencil, may result not only in incorrect operation, but also damage to the touch sensor.
- Do not touch the touch sensor with your fingertips. Doing so may cause your fingernail to break.

Notes on use

- If the product does not operate at all or as intended when touched, check to make sure that your other fingers, parts of your hand, or clothing items are not in contact when touching. Also, the product may not operate correctly if you are wearing gloves or if your fingertips are too dry.
- The product may not operate correctly if the touch sensor is dirty from sweat. Remove the dirt before operating the product.

About the active noise-cancelling function

The product is designed to use its built-in microphone to pick up noise from the surrounding environment (noise from vehicles, noise from air conditioners, etc.) and to cancel out that noise by producing sounds in negative phase. This results in a reduction in the sounds in your environment.

- The product's noise-cancelling function is mainly effective against noises in the lower frequency range, but not all noises are cancelled.
- Depending on the type of noise (or in quiet locations), you may not notice the noise-cancelling effect.
- A slight humming sound may be heard when using the noise-cancelling function. This is a sound generated by the noise-cancelling function; it is not a malfunction.
- The noise-cancelling effect may vary or a bleep (howling) may occur depending on how you wear the product. In these cases, take off the product and put the product in your ears again correctly.
- To maximize the noise-cancelling effect, select the eartips that offer the best sound insulation for each side to block surrounding sound, and insert the headphones into the ears correctly.
- When you use the product in a train or a vehicle such as bus or truck, noise may be heard depending on rail/street conditions.

About water-resistant (drip-proof) performance

- The water-resistant (drip-proof) specification of this product applies only to the headphones, not the charging case.
- Although the headphones have water-resistant (drip-proof) capabilities equivalent to IPX4, the part where the sound comes from is not water-resistant (drip-proof).
- The water-resistant (drip-proof) performance is designed to protect the headphones if they get wet from rain, etc. (equivalent to IPX4). JIS/IEC protection grade IPX4 means that the product is protected against exposure to flying water from all directions.
- The headphones cannot be used underwater.
- The headphones cannot be used in hot and humid places, such as bathrooms.
- The headphones are not waterproof. Submerging them in water may cause damage.
- The headphones may not function properly if they become wet. Wipe the headphones with a dry cloth, shake them multiple times to remove any excess water, and allow the headphones to dry thoroughly before use.

For a more comfortable Bluetooth communication experience

The effective communication range of this product varies depending on obstructions and radio wave conditions. For a more enjoyable experience, please use the product as close as possible to the Bluetooth device. To minimize noise and sound disruptions, avoid placing your body or other obstacles between the product's antenna and the Bluetooth device.

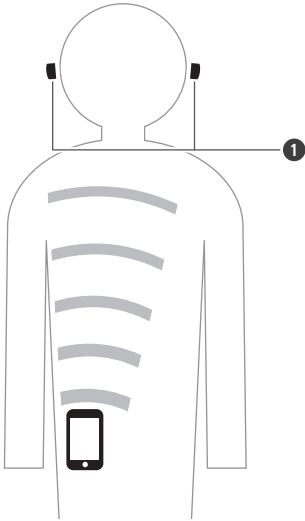

1 Antenna

Part names and functions

Headphones

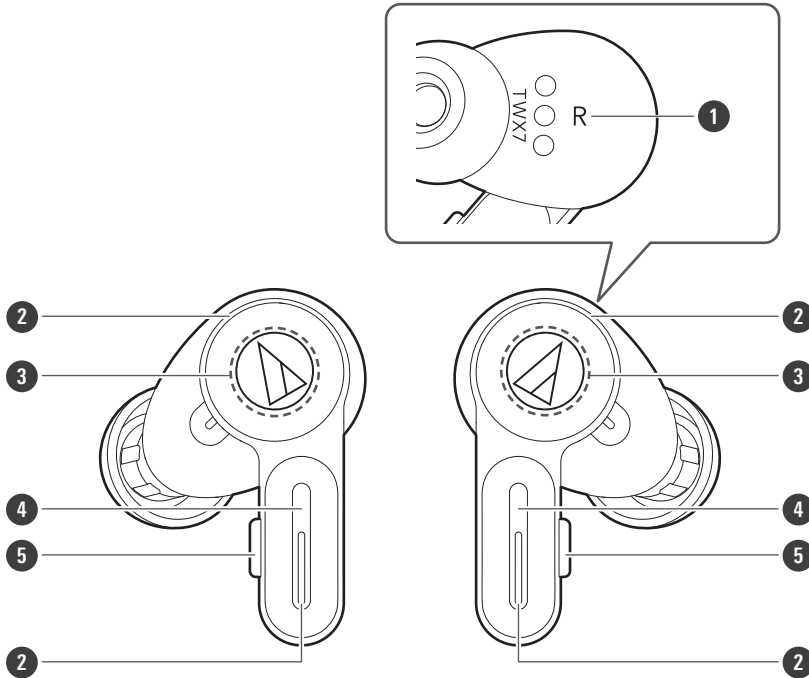

1 L/R (left/right) indicator

2 Microphone

3 Touch sensor

Use to operate specific functions, such as switching ambience control.

4 Indicator lamp

Displays the operating status and battery level of the headphones.

5 Multifunction button

Use to play/pause music and answer phone calls. Also use to adjust the volume (+/-).

Charging case

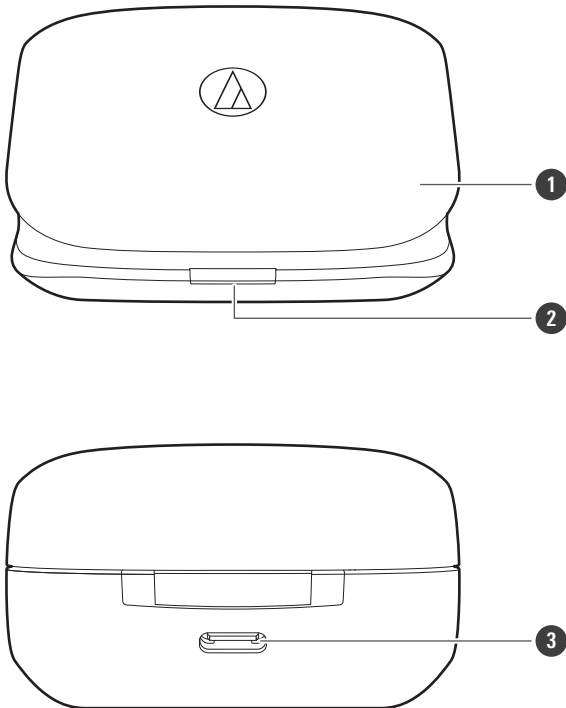

1 Cover

2 Indicator lamp

Lights/flashes when charging the charging case. Also displays the battery level of the charging case.

3 Battery jack

Use to connect the included USB charging cable and charge the product.

Accessories

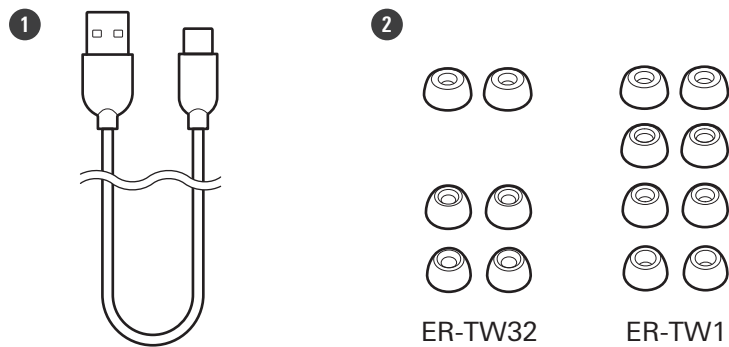

1 USB charging cable (30 cm (12"), USB Type-A / USB Type-C)

2 Eartips (ER-TW32/ER-TW1) (XS, S, M, L)

At the time of purchase, the M-size eartips (ER-TW32) are attached to the product.

Removing the insulation seal

Remove the insulation seal before use.

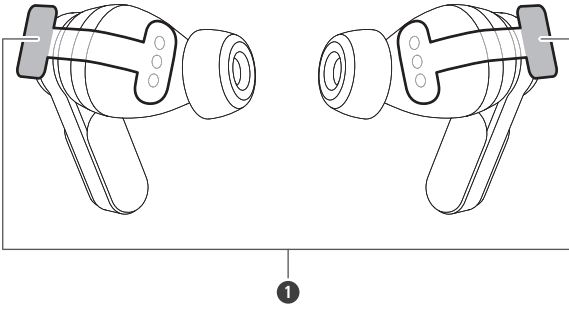

1 Insulation seal

Charging the battery

- Fully charge the battery when using for the first time.
- When the rechargeable battery is running low, the voice guidance will play the message “Low battery”, and the indicator lamps will flash in orange. Charge the battery as soon as possible.
- It takes about 1.5 hours to fully charge the headphones, and about 3 hours to fully charge the charging case. (Charging times may vary depending on usage conditions.)
- Charge the product in a well-ventilated place (10 to 35°C (50 to 95°F)) away from direct sunlight. Charging outside the normal charging temperature range may result in failure to charge or longer charging time. Also, the battery may deteriorate, possibly resulting in shorter periods of continuous use or failure to charge.

Charging the headphones and charging case

1 Connect the included USB charging cable (USB Type-C side) to the battery jack of the charging case.

- The included USB charging cable is designed for exclusive use with the product. Do not use any other USB charging cable.
- When inserting the USB charging cable into the USB port or battery jack, insert it directly (horizontally).

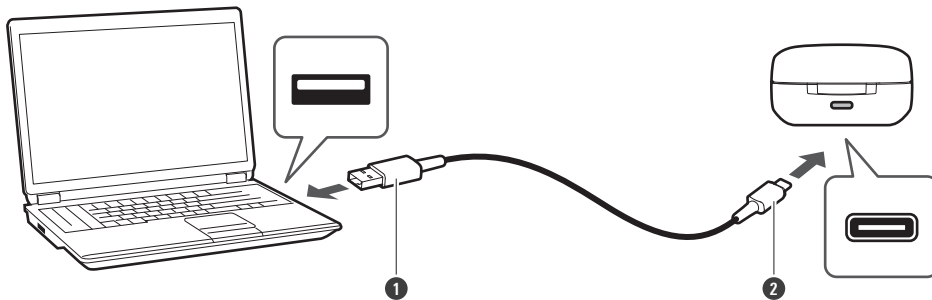

- ① USB Type-A
- ② USB Type-C

2 Place the headphones in the charging case.

- When charging the headphones, make sure the indicator lamps on the headphones light up. If they do not light up, remove the headphones and place them in the case again.

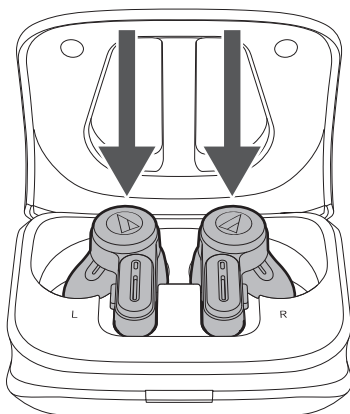

Charging the battery

3 Connect the included USB charging cable (USB Type-A side) to the computer to start charging.

- While charging, the indicator lamp on the charging case lights/flashes as follows. (It may take several seconds for the indicator lamp to light.)

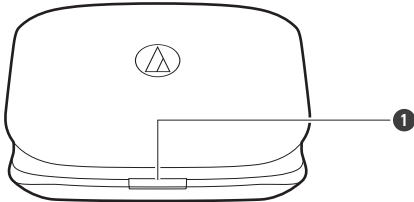

1 Indicator lamp

| Indicator lamp | Status |
|--|--|
| Flashing orange -> Flashing yellow -> Flashing green | Charging (The indicator lamp flashes orange when the battery level is low and changes to yellow then green as the battery level increases.) |
| Lights in green for 7 seconds, and then turns off | Charging complete |
| Flashing orange (twice) | Battery has no power |
| Flashing orange quickly | Charging error ^[1] |
| Flashing red | Error detected ^[2] |

[1] The charging case or headphones may be hot. Allow the temperature of the product to cool sufficiently before charging in a well-ventilated place (10 to 35°C (50 to 95°F)) away from direct sunlight.

[2] Discontinue use of the product and contact your local Audio-Technica dealer for repair.

4 When charging is complete, disconnect the USB charging cable (USB Type-A side) from the computer.

5 Disconnect the USB charging cable (USB Type-C side) from the battery jack on the charging case.



- When charging, make sure to use the included USB charging cable. The product may not charge with cables other than the included USB charging cable.
- Always make sure the headphones are not wet before charging. The headphones may not operate correctly or may not turn on if they are wet. Wipe the headphones with a dry cloth, shake them multiple times to remove any excess water, and allow the headphones to dry thoroughly before charging.

Charging headphones without the USB charging cable

A rechargeable battery is built into the charging case. If you have charged the charging case, you can charge the headphones without using the USB charging cable.

Charging the battery

1 Place the headphones in the charging case.

- While charging, the headphone indicator lamps light as follows. (It may take several seconds for the indicator lamps to light.)
- When charging the headphones, make sure the indicator lamps on the headphones light up. If they do not light up, remove the headphones and place them in the case again.

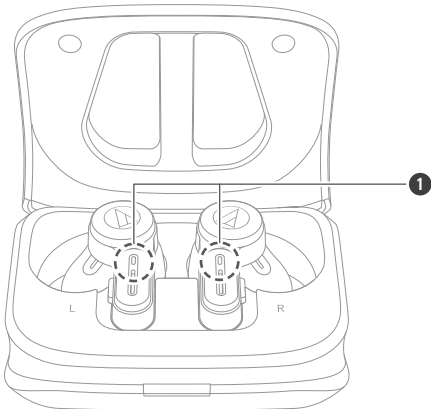

1 Indicator lamp

| Indicator lamp | Status |
|-----------------|--|
| Lights in white | Charging |
| Off | Charging complete / Charging case battery has no power |

Checking the battery level of the charging case

When opening/closing the cover of the charging case, the indicator lamp flashes to indicate the battery level of the charging case.

1 Open/close the charging case cover.

- The indicator lamp flashes as follows. The color of the indicator lamp indicates the battery level.

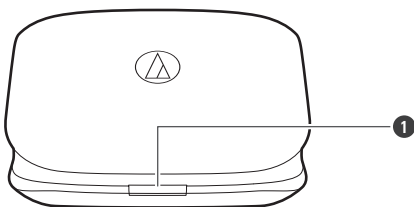

1 Indicator lamp

Charging the battery

| Indicator lamp | Status |
|---------------------------------|--|
| Flashing orange slowly (once) | Battery level low |
| Flashing yellow slowly (once) | Battery level medium |
| Flashing green slowly (once) | Battery level high |
| Flashing orange quickly (twice) | Battery is discharged. Charge the charging case. |

Wireless charging

Wireless charging is possible using commercially available Qi wireless chargers.

- A wireless charger is not included. Please purchase one separately.
- Close the charging case cover and place the charging case on the wireless charger. The indicator lamp of the charging case lights and flashes in the same manner as when charging with a USB charging cable.
- When charging, refer to the user manual for the wireless charger to confirm the correct placement method.
- The maximum power that can be received by this product is 2.5 W.

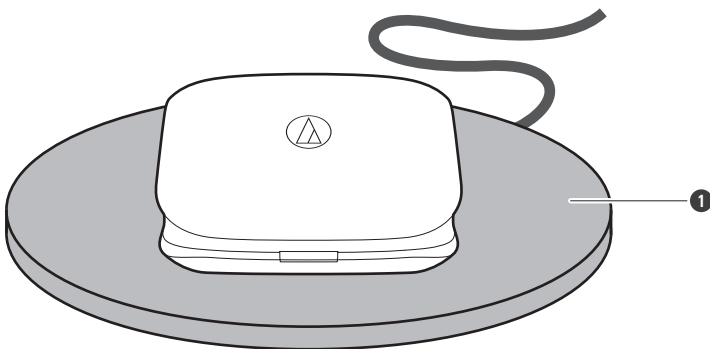

1 Wireless charger



- Charging simultaneously with a wireless charger and USB charging cable is not possible.



- Do not allow any objects between the charging case and the wireless charger when charging. For details, refer to the user manual of your wireless charger.

Power supply ON/OFF

Turning on the product

- 1 Remove the headphones from the charging case.

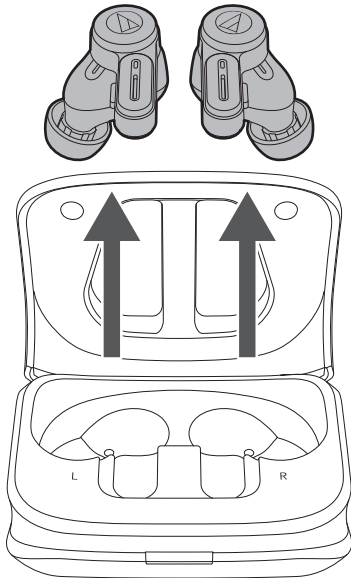

» The power will turn on automatically and the indicator lamps on the headphones will light in white and then flash.



- Press and hold (for about 2 seconds) the multifunction buttons to turn the power on manually.
- It may take several seconds for the indicator lamps to light.

Turning off the product

- 1 Place the headphones in the charging case.

Power supply ON/OFF

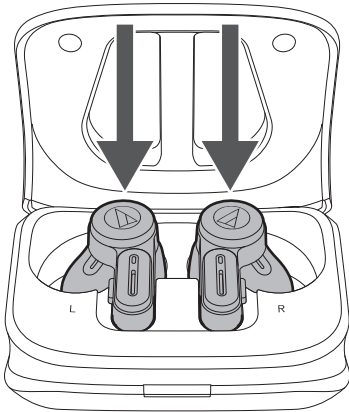

» The power will turn off automatically.



- Press and hold (for about 4 seconds) the multifunction buttons to turn off the power manually.

Connecting via Bluetooth

To connect the product to a Bluetooth device, the product needs to pair (register) with the device.

Pairing a Bluetooth device

- Read the user manual for the Bluetooth device.
- Place the Bluetooth device within 1 m (3.3') of the product to perform pairing correctly.
- Wear the product to hear voice guidance during pairing.

1 Remove the headphones (L (left) and R (right)) from the charging case.

- The indicator lamps on the headphones will light in white, and then flash.

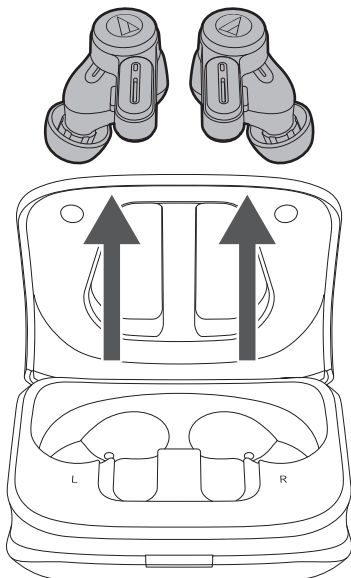

2 Use your Bluetooth device to begin the pairing process and search for the product. When your Bluetooth device finds the product, "ATH-TWX7" will be displayed on the device.

- For information about using your Bluetooth device, refer to the device's user manual.

3 Select "ATH-TWX7" to pair the product and your Bluetooth device.

- Some devices may ask for a passkey. In this case, enter "0000". The passkey may also be called a passcode, PIN code, PIN number, or password.

Connecting via Bluetooth

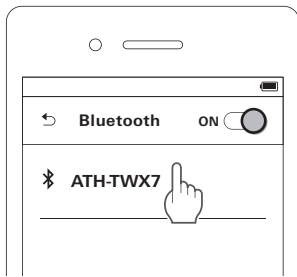

» The voice guidance will play the message “Connected”, and the indicator lamps on the headphones will flash slowly in white. This indicates pairing was successfully completed.

Pairing with Fast Pair

In one touch, the product enables quick, effortless Bluetooth pairing with your Android devices. You can even check to see where you last placed it.



- 1** Turn on the Bluetooth function on an Android device configured with a Google account.
- 2** Remove the headphones (L (left) and R (right)) from the charging case and bring them close to the Android device.

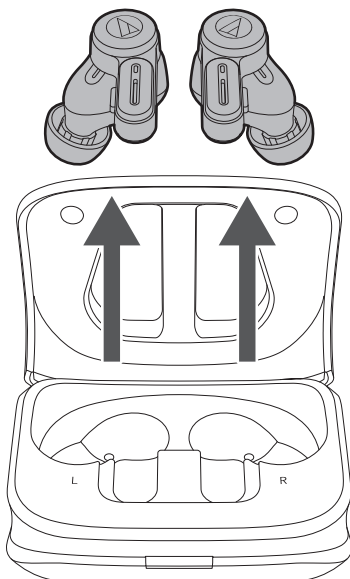

Connecting via Bluetooth

3 Touch the pairing notification that appears on your Android device.

» The voice guidance will play the message "Connected", and the indicator lamps on the headphones will flash slowly in white. This indicates pairing was successfully completed.

About pairing

When connecting a new Bluetooth device, you need to pair it with the product. Once the Bluetooth device and the product are paired, you do not need to pair them again. The product supports multipairing, in which a connection history is saved. However, in the following cases you will need to pair again even if the Bluetooth device was paired once:

- If the product is deleted from the Bluetooth device's connection history.
- If the product is sent out for repair.
- If the product is reset.

Multipoint function

The product supports multipoint, which allows two Bluetooth devices to be connected at the same time. While you are listening to music with one device, you can answer a call that comes in from the other device. It is convenient if you have two smartphones, for example.

- To use this function, turn on multipoint connections under "Connected Device Management" in Audio-Technica's "CONNECT" smartphone app. Refer to "App for smartphones" (p. 30).
- Audio-Technica does not guarantee the operation of all combinations of Bluetooth devices.

Connecting using multipoint

- 1 Pair with the first Bluetooth device.
- 2 After pairing with the first device, turn off its Bluetooth feature.
- 3 Pair with the second Bluetooth device.
- 4 Turn on the Bluetooth feature of the first Bluetooth device.



- If the product does not connect, restart its power.
- Up to two Bluetooth devices can be connected at the same time with multipoint. To connect a third Bluetooth device, disconnect one of the connected devices.
- Music cannot be played back on two devices at the same time. If music is playing on the first device, music will not play on the second device even if attempted. Stop playback on the first device before attempting to play music on the second device.

Wearing the product

Insert the side of the product marked "L" (left) into the left ear and the side marked "R" (right) into the right ear.

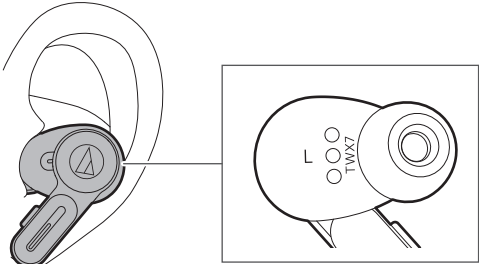

Touch sensors

The product has touch sensors. When performing operations, touch the sensors using the pad of your finger, not the fingertip.

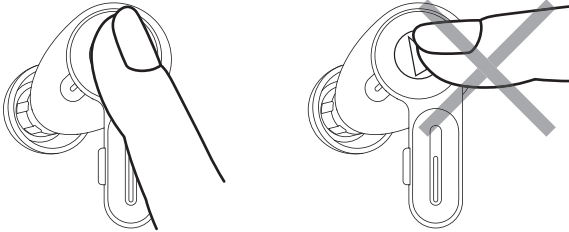

- Operate the touch sensor with one finger. Operating with a sharp-tipped object, such as a ballpoint pen or pencil, may result not only in incorrect operation, but also damage to the touch sensor.
- Do not touch the touch sensor with your fingertips. Doing so may cause your fingernail to break.
- If the product does not operate at all or as intended when touched, check to make sure that your other fingers, parts of your hand, or clothing items are not in contact when touching. Also, the product may not operate correctly if you are wearing gloves or if your fingertips are too dry.
- The product may not operate correctly if the touch sensor is dirty from sweat. Remove the dirt before operating the product.

Using the product

The product can use Bluetooth wireless technology to connect to your device and play music, receive phone calls, etc. Use the product for whichever of these purposes suits your needs. Note that Audio-Technica cannot guarantee the operation of displays, such as the battery level display, or applications via Bluetooth devices.

Listening to music

- To connect for the first time, pair the product and your device via Bluetooth wireless technology. If you have already paired the product and your Bluetooth device, turn on the Bluetooth device's Bluetooth connection before turning on the product.
- Use your Bluetooth device to start playback, referring to the device's user manual as necessary.

1 Remove the headphones from the charging case and place them in your ears.

2 Start playback on your Bluetooth device.

3 Press the multifunction button on the L (left) side headphone once or twice in a row to adjust the volume (up or down).

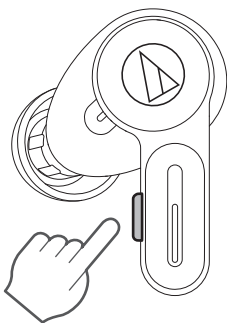

4 To pause music, press the multifunction button on the R (right) side headphone.

- Playback will be started or paused with every press.



- Listening to music is also possible with only one headphone by removing only one side from the charging case and putting it in your ear. When you use only one headphone, some functions are not available depending on which side is worn. Use the Bluetooth device for operation in such cases.

Using the product

R (right) side headphone multifunction-button operation

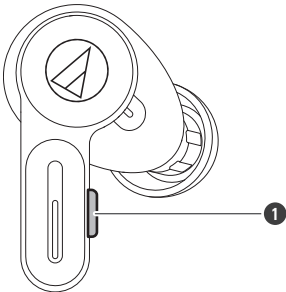

1 Multifunction button

| Operation | Function |
|---------------------|---|
| Press | Starts or pauses playback. |
| Press (twice) | Plays the next track. |
| Press (three times) | Plays the previous track / returns to the start of the track. |

- The controls explained above may not be available on some smartphones.

L (left) side headphone multifunction-button operation

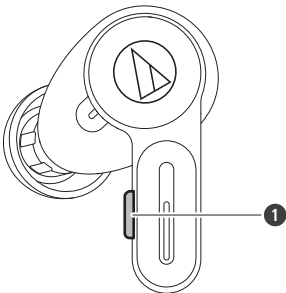

1 Multifunction button

| Operation | Function |
|---------------|---|
| Press | Increases the volume by 1 level. ^[1] |
| Press (twice) | Decreases the volume by 1 level. ^[1] |

[1] The volume control of some Bluetooth devices may not work well with the product.

- The controls explained above may not be available on some smartphones.

Talking on the phone

If your Bluetooth device supports telephone features, you can use the product to talk on the phone.

Using the product

- 1 Remove the headphones from the charging case and place them in your ears.**
- 2 Make/receive calls with your Bluetooth device.**
 - When your Bluetooth device receives a phone call, the product sounds a ringtone.
 - If a call is received while you are listening to music, music playback is paused.
- 3 To receive a call, press the multifunction button on the L (left) or R (right) side headphone.**
 - Calls can be answered from either the L (left) or R (right) side headphone.
- 4 Press the multifunction button on the L (left) side headphone once or twice in a row to adjust the volume (up or down).**

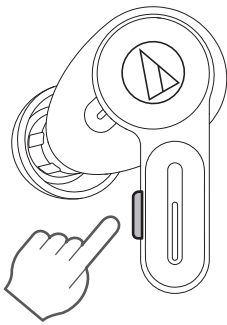

- 5 To end the call, press and hold (about 2 seconds) the multifunction button on the L (left) or R (right) side headphone.**
 - Calls can be ended from either the L (left) or R (right) side headphone.
 - If the call was received while listening to music, playback is resumed.
 - Music playback may not be resumed on some Bluetooth devices. In this case, music playback must be started manually.



- Making/receiving calls is also possible with only one headphone by removing only one side from the charging case and putting it in your ear. When you use only one headphone, some functions are not available depending on which side is worn. Use the Bluetooth device for operation in such cases.

Notes for talking on the phone

When talking on the phone, make sure the tips of the headphones (microphones) are angled toward your mouth as shown in the figure. If the headphones are not oriented correctly, your voice may be too quiet for others to hear.

Using the product

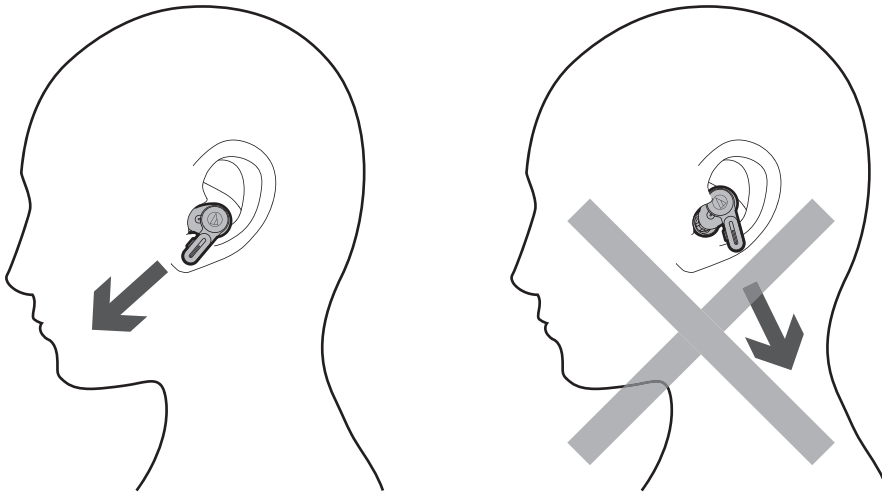

R (right) side headphone multifunction-button operation

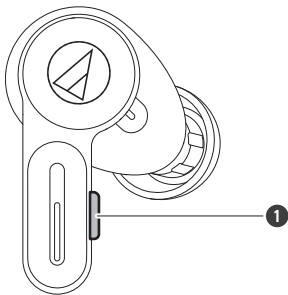

1 Multifunction button

| Operation | Function |
|----------------------------------|--|
| Press | Receiving a call: Answers the call. |
| Press (twice) | Mutes the microphone. ^[1] |
| Press and hold (about 2 seconds) | Receiving a call: Rejects the call. Making a call: Cancels the call. During a call: Ends the call. |

[1] The mute operation using the multifunction button only mutes the headphones and does not activate the mute function on the Bluetooth device.

- The controls explained above may not be available on some smartphones.

Using the product

L (left) side headphone multifunction-button operation

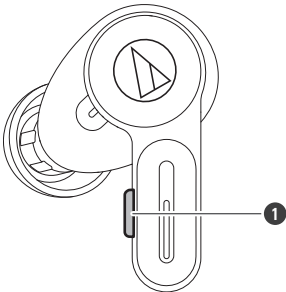

1 Multifunction button

| Operation | Function |
|----------------------------------|--|
| Press | Receiving a call: Answers the call. During a call: Increases the call volume by 1 level. |
| Press (twice) | During a call: Decreases the call volume by 1 level. |
| Press and hold (about 2 seconds) | Receiving a call: Rejects the call. Making a call: Cancels the call. During a call: Ends the call. |

- The controls explained above may not be available on some smartphones.

Talk-through function

This function enhances external sound by focusing on people's voices. The volume of music being played back decreases automatically. It is useful for when you want to listen to public transportation announcements or people's voices.

1 Touch the touch sensor on the headphone (L (left) or R (right) side) twice in a row.

- Either the L (left) or R (right) side headphone can be used.
- The voice guidance will play the message "Talk-through". Touch the sensor twice in a row again to turn off the talk-through function.

Conditions for turning off the talk-through function

In addition to the above procedure, the talk-through function turns off when the following operations and actions are performed.

- When the multifunction button on the L (left) or R (right) side headphone is pressed. (If music is being played back, pressing the multifunction button once on the R (right) side will pause the music. The talk-through function will not turn off. Press the multifunction button again to turn off the talk-through function and resume music playback.)
- When the touch sensor on the L (left) or R (right) side headphone is touched.

Using the product

- When you are making a call / receiving a call / talking on the phone.
- When the volume is adjusted from a connected Bluetooth device.
- When one headphone is off.
- When both headphones are off.



- The talk-through function cannot be used during a call.



- Depending on your surroundings, the ambient sounds may be difficult to hear even when using the product's talk-through function. Do not use the product in places that are dangerous if you cannot hear the surrounding sounds, such as places with heavy traffic.
- When the talk-through function is turned ON, do not cover the microphone with your hand. If you do so, a loud sound (howling) will be emitted, and it may adversely affect your hearing ability.

Ambience control

The product includes an ambience control function for switching between the noise-cancelling function and hear-through function. The functions can be switched from noise-cancelling (default), to off, or hear-through.

| Function | Description |
|---------------------------|--|
| Noise-cancelling function | The microphone built into the product detects ambient noise and outputs a sound-cancelling signal to effectively reduce noise. |
| Hear-through function | This function allows you to hear surrounding sound via the built-in microphone while you listen to music. |

1 Touch and hold (about 2 seconds) the touch sensor on the L (left) side headphone.

» The functions can be switched from noise-cancelling (default), to off, or hear-through.



- Depending on the volume of the music being played back, the surrounding sounds may be difficult to hear. In this case, turn down the volume of the music.
- Depending on your surroundings, the ambient sounds may be difficult to hear even when using the product's hear-through function. Do not use the product in places that are dangerous if you cannot hear the surrounding sounds, such as places with heavy traffic.
- When the hear-through function is turned ON, do not cover the microphone with your hand. If you do so, a loud sound (howling) will be emitted, and it may adversely affect your hearing ability.

Speech recognition feature

Activation of the speech recognition feature (such as Siri) may be possible depending on your device.

Using the product

1 Touch and hold (about 2 seconds) the touch sensor on the R (right) side headphone.

» The speech recognition feature (such as Google Assistant or Siri) is activated.

Auto power off function

The headphones turn off automatically in the following situations.

- When the headphones are not connected to a Bluetooth device for 5 minutes
- When music is paused for 60 minutes after pairing is performed

App for smartphones

This product is compatible with our “CONNECT” app. The app gives you convenient access to various functions. It also allows you to update the product’s firmware.

<https://app.at-globalsupport.com>



CONNECT App
iOS, Android

What you can do with the app

The app allows you to use the following functions. For details, refer to the app screen.

Using the product

| Function | Description |
|-----------------------------|--|
| Ambience Control | You can switch between the noise-cancelling and hear-through functions. |
| Talk-Through | You can turn the talk-through function on or off, set the talk-through type, and adjust the music playback volume for talk-through. |
| Equalizer | You can adjust the equalizer settings. |
| Audio Codecs | You can change the connection codec. |
| Soundscape | You can download and play relaxing nature sounds designed for improving sleep and calmness, masking noises to enhance concentration, and healing sounds for refreshing your mind and body or meditating. |
| Low Latency Mode | Limit playback sound delay while playing games or watching videos. Bluetooth communication can be easily affected by obstacles and radio wave conditions. Turn this mode off in such situations. |
| Volume Adjustment Level | The number of volume adjustment steps can be changed. |
| L/R Balance Adjustment | You can adjust the left-right volume balance. |
| Call Microphone | Select from two modes for the audio delivered to the other party during a call: Natural Mode or Noise-Reduction Mode. |
| Private Timer | Select whether to hear alarm sounds from the headphones to notify you of set timers. This function will only be enabled when the headphones are turned on. |
| Key Assign | You can set the function assigned to the multifunction button or touch sensor. |
| Touch Sensors | You can turn touch sensors on or off and set their sensitivity levels. You can also configure the touch sensor lock setting. |
| Auto Power Off | You can turn the auto power off function on or off and set the time until the headphones are turned off. |
| Voice Guidance | You can change the product's voice guidance to a confirmation tone, or switch the voice guidance language. |
| Connected Device Management | You can switch the connection by selecting the Bluetooth device you want to connect from the list of Bluetooth devices you have connected to so far. You can also remove connected devices and turn multipoint connectivity on or off. |

Indicator lamps on the headphones

Pairing

| Status | Indicator lamp display pattern |
|-----------------------|---|
| Searching for devices | ○ - ○ - ○ . . . Flashing white (gradually lighting up) |

Connecting

| Status | Indicator lamp display pattern |
|------------------|---|
| Connecting | ○-----○-----○ . . . Flashing white in 5-second intervals |
| Music is playing | ----- . . . Off |

Battery level

| Status | Indicator lamp display pattern |
|----------------------|---|
| Battery level is low | White in the pairing or connection status turns orange. |

Voice guidance

The product plays English voice guidance in the following situations.
Use the "CONNECT" app to change the voice guidance language.

| Situation | Voice guidance |
|---|------------------|
| Bluetooth is connected | Connected |
| Bluetooth is disconnected | Disconnected |
| Noise-cancelling function on (ambience control) | Noise-cancelling |
| Hear-through function on (ambience control) | Hear-through |
| Off (ambience control) | Off |
| Talk-through function on | Talk-through |
| Low latency mode on | Low latency |
| Low latency mode off | Low latency off |
| Maximum volume | Max |
| Minimum volume | Minimum |
| Microphone mute on (during a call) | Mic off |
| Microphone mute off (during a call) | Mic on |
| Battery level is low | Low battery |
| No power due to dead battery | Please recharge |

Cleaning

Get into the habit of regularly cleaning the product to ensure that it will last for a long time. Do not use alcohol, paint thinners, or other solvents for cleaning purposes.

- Wipe any dirt off the headphones and charging case with a dry cloth. The headphones may not operate correctly or may not turn on if they are wet. Wipe the headphones with a dry cloth, shake them multiple times to remove any excess water, and allow the headphones to dry thoroughly before use.
- Immediately wipe off sweat or any other moisture from the charging case battery jack, the headphone charging terminals, etc. Failure to do so may result in a malfunction due to corrosion.
- Natural oils from the skin are particularly likely to build up on the eartip attachment parts (see figure). If these areas are not cleaned, the eartips can become detached. Clean them regularly. Do not touch the areas where sound is produced as they are delicate. Doing so may result in malfunction.
- If any moisture remains in the openings such as the sound reproduction part, microphone, or vent (see figure), place the headphones on a dry cloth and shake several times to remove any moisture, and then allow the headphones to dry thoroughly before use.
- Wipe away any perspiration or dirt from the USB charging cable with a dry cloth immediately after use. Failure to clean the cable may cause it to deteriorate and harden over time, resulting in malfunction.
- If the USB terminal of the USB charging cable is dirty, wipe it off with a dry cloth.
- Clean the eartips by removing them from the headphones and manually cleaning them with a diluted mild detergent. After cleaning, dry before using again.

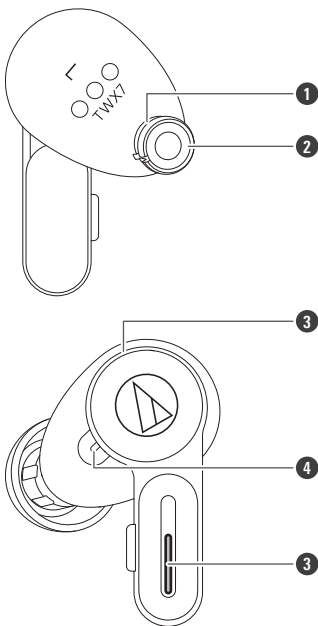

- ① Eartip attachment part
- ② Sound reproduction part
- ③ Microphone
- ④ Vent



- If the product will not be used for an extended period of time, store it in a well-ventilated place free from high temperatures and humidity.

Eartips

Selecting eartips

To provide better fit, two types of eartips are included with this product. Use the type that fits you best. Eartips are provided in four sizes (XS, S, M, and L). This applies both to the soft eartips (ER-TW32), which reduce strain on the ears even when used for long periods of time, and the firmer normal eartips (ER-TW1), which are designed to provide better fit and stability. At the time of purchase, the M-size soft eartips (ER-TW32) are attached to the product.

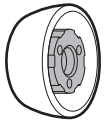

ER-TW32

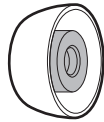

ER-TW1

Eartip size

The product includes two types of silicone eartips in four sizes (XS, S, M, and L). At the time of purchase, the M-size soft eartips (ER-TW32) are attached. To ensure the best sound quality, select the eartip size that is best suited for you, and adjust the eartips inside your ears for a snug fit. It may be difficult to hear bass sounds if the eartips do not fit snugly in your ears.

Replacing the eartips

Remove the old eartip and attach the new eartip by pushing it onto the headphone at an angle. Push firmly on the eartip so that the inside of the eartip expands, and push the eartip onto the post as far as it will go.

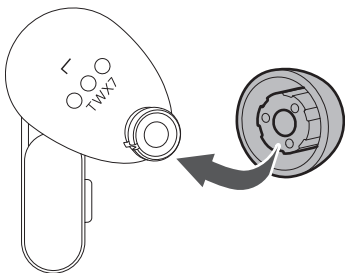

- Eartips are consumable parts that degrade through storage and use. If the eartips are loose and easily removed or if they appear to have degraded, purchase replacements.



- Periodically remove and clean the eartips as they become dirty easily. Using dirty eartips may cause the headphones themselves to become dirty, resulting in deteriorated sound quality.
- When reattaching eartips that were previously removed, be sure to check that they are securely attached. Injury or illness may occur if the eartips become detached and are left inside the ear.

Forced pairing mode / reset

If the product does not connect to a device (forced pairing mode)

If pairing cannot be cancelled or is not successful, you can use forced pairing mode to perform pairing again.

1 After both headphones (L (left) and R (right) sides) are placed in the charging case (with battery remaining) and the headphone indicator lamps turn on, touch and hold (about 4 seconds) the touch sensors of both headphones.

2 When the indicator lamps on both headphones light in orange, release your fingers and remove the headphones from the charging case.

» The product will switch to the "searching for devices" (pairing mode) state and you will be able to pair with your desired Bluetooth device.



- If the procedure cannot be completed as expected, remove the headphones from the charging case again and repeat the procedure from the beginning.

If the product operates abnormally (reset)

Reset the product.

1 After both headphones (L (left) and R (right) sides) are placed in the charging case (with battery remaining) and the headphone indicator lamps turn on, touch and hold (about 10 seconds) the touch sensors of both headphones.

- While touching and holding the touch sensors, the indicator lamps will light in orange once after about 4 seconds, but keep pressing and holding the touch sensors.

2 When the indicator lamps on both headphones begin flashing orange, release your fingers and remove the headphones from the charging case.

» Reset is complete.

3 Remove the product from the list of registered devices on your Bluetooth device.

4 Perform pairing again.



- If the procedure cannot be completed as expected, remove the headphones from the charging case again and repeat the procedure from the beginning.

Troubleshooting

? Power is not supplied

- Charge the product.

? Unable to pair

- Confirm that the Bluetooth device communicates using Ver. 2.1+EDR or higher.
- Place the product and the Bluetooth device within 1 m (3.3') of each other.
- Set the profiles for the Bluetooth device. For procedures on how to set profiles, refer to the Bluetooth device's user manual.
- Remove the pairing information for the Bluetooth device then pair the product with this device again.
- Place the headphones in the charging case and close the cover, then remove the headphones and perform the operation again.
- Make sure you are not connected to any other previously connected Bluetooth device. If so, disconnect the product using the previously connected Bluetooth device, and then select the product on the Bluetooth device being connected to. Use forced pairing mode if you are unable to disconnect from a previously connected Bluetooth device. For details, refer to "If the product does not connect to a device (forced pairing mode)" (p. 36).
- Reset the product if it cannot be unpaired, connected, or does not operate as expected even after trying all other solutions. For details, refer to "If the product operates abnormally (reset)" (p. 36).

? No sound is heard / Sound is faint

- Turn on the power of the product and the Bluetooth device.
- Turn up the volume on the product and the Bluetooth device.
- Make sure that the product and Bluetooth device are connected by the A2DP (or audio connection).
- Disable pairing for the product and the Bluetooth device, then pair the product with this device again.
- Move away from obstacles between the product and the Bluetooth device, such as people, metal, or walls, and place the product and device closer together.
- Switch the sound output of the Bluetooth device to the product.
- Check whether the talk-through function is turned on/off. If the talk-through function is on, the volume of music being played back will decrease automatically. For details on operating the talk-through function, refer to "Talk-through function" (p. 28).

? Sound only comes out of one headphone

- Make sure there is battery level remaining.
- Place the headphones in the charging case and close the cover, then remove the headphones and perform the operation again.

? **Sound is distorted / Noise is heard / Sound cuts out**

- Turn down the volume on the product and the Bluetooth device.
- Keep the product away from devices that emit radio waves such as microwaves and wireless routers.
- Keep the product away from TVs, radios, and devices with built-in tuners. These devices can also be affected by the product.
- Turn off the equalizer settings of the Bluetooth device.
- Remove obstacles between the product and the Bluetooth device and place them closer together. For details, refer to "For a more comfortable Bluetooth communication experience" (p. 9).
- You may be able to improve the connection status by switching the connection codec to SBC. You can change it with our smartphone app. If you are using a connected device such as a smartphone or audio player that can change the connection codec, you may be able to set to SBC on that connected device. For details about the setting procedure, refer to the user manual of your connected device.

? **Noise is generated when using the noise-cancelling function**

- A slight humming sound may be heard when using the noise-cancelling function. This is a sound generated by the noise-cancelling function; it is not a malfunction.
- The noise-cancelling effect may vary or a bleep (howling) may occur depending on how you wear the product. In these cases, take off the product and put the product in your ears again correctly.
- To maximize the noise-cancelling effect, select the eartips that offer the best sound insulation for each side to block surrounding sound, and insert the headphones into the ears correctly.
- When you use the product in a train or a vehicle such as bus or truck, noise may be heard depending on rail/street conditions.
- If soft eartips (ER-TW32) are being used, replacing the eartips with the included normal eartips (ER-TW1) may reduce noise.

? **Cannot hear the voice of the caller / Voice of the caller is too quiet**

- Turn on the power of the product and the Bluetooth device.
- Turn up the volume on the product and the Bluetooth device.
- Confirm that the product and Bluetooth device are connected via HFP (or phone connection).
- Disable pairing for the product and the Bluetooth device, then pair the product with this device again.
- Switch the sound output of the Bluetooth device to the product.

My voice is too quiet for others to hear

- Make sure the product is oriented correctly with the tip (microphone) as close as possible to your mouth. For details, refer to "Notes for talking on the phone" (p. 26).

Charging case cannot be charged

- Securely connect the included USB charging cable and charge the product.
- The charging case or headphones may be hot. Allow the temperature of the product to cool sufficiently before charging in a well-ventilated place (10 to 35°C (50 to 95°F)) away from direct sunlight.

The charging case gets unusually hot during wireless charging

- Make sure no objects are caught between the charging case and the wireless charger. Do not allow any objects between the charging case and the wireless charger when using wireless charging. For details, refer to the user manual of your wireless charger.

Headphones cannot be charged

- Make sure that the product is placed in the charging case correctly.
- Make sure to close the charging case cover when charging.
- Charge the charging case.
- Wipe dirt off the charging terminal with a dry cloth.
- The charging case or headphones may be hot. Allow the temperature of the product to cool sufficiently before charging in a well-ventilated place (10 to 35°C (50 to 95°F)) away from direct sunlight.

Headphone indicator lamps flash in red quickly

- After placing the headphone whose indicator lamp is flashing in red quickly in the charging case (with battery remaining), press and hold (about 2 seconds) the headphone multifunction button. The indicator lamp will then stop flashing.

Touch sensors operate abnormally

- Has touch sensor sensitivity been changed using our "CONNECT" app? Touch sensor operation may vary depending on the unique finger characteristics and movements of the user. Changing touch sensor sensitivity may improve operability.



- For details about how to operate your Bluetooth device, refer to the device's user manual.

Specifications

Headphones

| | |
|---------------------------|-----------------|
| Type | Dynamic |
| Driver | 5.8 mm |
| Sensitivity | 100 dB/mW |
| Frequency response | 10 to 40,000 Hz |
| Impedance | 16 ohms |

Microphones

| | |
|---------------------------|---------------------------|
| Type | MEMS type |
| Polar pattern | Omnidirectional |
| Sensitivity | -38 dB (1 V/Pa, at 1 kHz) |
| Frequency response | 100 to 16,000 Hz |

Communication specifications

| | |
|--|--|
| Communication system | Bluetooth version 5.1 |
| Maximum RF output | 12 mW EIRP |
| Maximum communication range | Line of sight - approx. 10 m (33') |
| Frequency band | 2.402 GHz to 2.480 GHz |
| Modulation method | GFSK, Pi/4DQPSK, 8DPSK |
| Spread spectrum method | FHSS |
| Compatible Bluetooth profiles | A2DP, AVRCP, HFP |
| Supported codec | LDAC, AAC, SBC |
| Supported content protection method | SCMS-T |
| Supported sample rates | 44.1 kHz, 48 kHz, 96 kHz ^[1] |
| Supported bit depth | 16 bit, 24 bit ^[1] |
| Transmission band | 10 Hz to 47,000 Hz (when using LDAC 96 kHz sampling) 20 Hz to 20,000 Hz |

Other

| | |
|---|--|
| Power supply | Headphones: DC 3.85 V lithium ion battery Charging case: DC 3.85 V lithium ion battery |
| Charging time | Headphones: Approx. 1.5 hours ^[2] Charging case: Approx. 3.0 hours (USB charging) ^[3] , Approx. 5.0 hours (wireless charging) ^[3] |
| Operating time | Continuous transmission time (music playback): Max. approx. 6.5 hours (headphones only; noise-cancelling on) ^[3] , Max. approx. 7.5 hours (headphones only; noise-cancelling off) ^[3] , Max. approx. 20.0 hours (charging case + headphones; noise-cancelling on) ^[3] , Max. approx. 24.0 hours (charging case + headphones; noise-cancelling off) ^[3] |
| Weight | Headphones: Approx. 4.7 g (0.17 oz) (L side), approx. 4.7 g (0.17 oz) (R side) / Charging case: Approx. 47.5 g (1.7 oz) |
| Water-resistant (drip-proof) performance | IPX4 ^[4] |
| Operating temperature | 5°C to 40°C (41°F to 104°F) |
| Accessories | USB charging cable (30 cm (12"), USB Type-A / USB Type-C), Soft eartips (XS, S, M, L), Normal eartips (XS, S, M, L) |
| Sold separately | Soft eartips (ER-TW32; XS, S, M, L) Normal eartips (ER-TW1; XS, S, M, L) |

[1] When using the LDAC codec.

[2] Charging may take longer at 10°C (50°F) and below or 30°C (86°F) and above.

[3] The figures above depend on operating conditions.

[4] Headphones only.

- For product improvement, the product is subject to modification without notice.

Trademarks

- The **Bluetooth**[®] word mark and logos are registered trademarks owned by Bluetooth SIG, Inc., and any use of such marks by Audio-Technica Corporation is under license. Other trademarks and trade names are those of their respective owners.
- USB Type-C[™] is a trademark of USB Implementers Forum.
- Google Play is a trademark of Google LLC.
- "SONY" is a registered trademark of Sony Group Corporation.
- LDAC[™] and LDAC logos are trademarks of Sony Corporation.



株式会社オーディオテクニカ

〒194-8666 東京都町田市西成瀬2-46-1
www.audio-technica.co.jp

Audio-Technica Corporation

2-46-1 Nishi-naruse, Machida, Tokyo 194-8666, Japan
www.audio-technica.com
©2023 Audio-Technica Corporation
Global Support Contact: www.at-globalsupport.com