



ATV-SG1

On-Camera Shotgun Microphone

User Manual

English

Safety precautions

Although this product was designed to be used safely, failing to use it correctly may result in an accident. To ensure safety, observe all warnings and cautions while using the product.

Cautions for the product

- Do not subject the product to strong impact to avoid malfunction.
- Do not disassemble, modify or attempt to repair the product.
- Do not handle the product with wet hands to avoid electric shock or injury.
- Do not store the product under direct sunlight, near heating devices or in a hot, humid or dusty place.

Battery caution

- The product is equipped with a rechargeable battery (lithium-ion battery).
- Keep batteries out of the reach of children.
- Do not expose the battery to excessive heat such as sunshine, fire or the like.
- Danger of explosion if battery is incorrectly replaced. Replace only with the same type.
- Always consider the environmental issues and follow local regulations when disposing of batteries.
- If battery fluid gets into eyes, do not rub them. Rinse thoroughly with clean water such as tap water and consult a doctor immediately.
- If battery fluid leaks, do not touch fluid with bare hands. If fluid remains inside the product, it may cause malfunction. If battery fluid leaks, contact your local Audio-Technica dealer.
 - If fluid gets in your mouth, gargle thoroughly with clean water such as tap water and consult a doctor immediately.
 - If your skin or clothing comes in contact with fluid, immediately wash the affected skin or clothing with water. If you experience skin irritation, consult a doctor.
- To avoid leakage, generation of heat or explosion:
 - Never heat, disassemble or modify the battery, nor dispose of it in a fire.
 - Do not attempt to pierce with a nail, hit with a hammer or step on the battery.
 - Do not drop the product or subject it to strong impact.
 - Do not get the battery wet.
- Do not use, leave or store the battery in the following places:
 - Area exposed to direct sunlight or high temperatures and humidity
 - Inside of a car under the blazing sun
 - Near heat sources such as heat registers
- Charge only with the included USB cable to avoid malfunction or fire.
- When the product is disposed of, the built-in rechargeable battery needs to be discarded properly. Contact your local Audio-Technica dealer to learn how to properly dispose of the battery.

For customers in the USA

FCC Notice

Warning

This device complies with Part 15 of the FCC Rules. Operation is subject to the following two conditions: (1) This device may not cause harmful interference, and (2) this device must accept any interference received, including interference that may cause undesired operation.

Caution

You are cautioned that any changes or modifications not expressly approved in this manual could void your authority to operate this equipment.

Note: This equipment has been tested and found to comply with the limits for a Class B digital device, pursuant to part 15 of the FCC Rules. These limits are designed to provide reasonable protection against harmful interference in a residential installation. This equipment generates, uses and can radiate radio frequency energy and, if not installed and used in accordance with the instructions, may cause harmful interference to radio communications. However, there is no guarantee that interference will not occur in a particular installation. If this equipment does cause harmful interference to radio or television reception, which can be determined by turning the equipment off and on, the user is encouraged to try to correct the interference by one or more of the following measures:

- Reorient or relocate the receiving antenna.
- Increase the separation between the equipment and receiver.
- Connect the equipment into an outlet on a circuit different from that to which the receiver is connected.
- Consult the dealer or an experienced radio/TV technician for help.

Contact:

Responsible Company: Audio-Technica U.S., Inc.
Address: 1221 Commerce Drive, Stow, Ohio 44224, USA
Tel: 330-686-2600

For customers in Canada

ISED statement

CAN ICES(B)/NMB(B)

Notes on use

- Be sure to read the connected device's user manual before use.
- When the product is used for a long time, the product may become discolored due to ultraviolet light (especially direct sunlight) and wear.
- Use the included cable for connection.
- Make sure to hold the plug when connecting and disconnecting the cable. The cable may become severed or an accident may occur if you pull on the cable itself.
- When using the cable, be careful not to twist it to prevent damage to the cable.
- Do not wind the cable at the base of the plug. Doing so may result in disconnection.
- When plugging the cable into the microphone and the connected device, check that the connector is facing in the correct direction before inserting it straight. Inserting the plug diagonally may cause a malfunction.
- When not in use, disconnect the cable from the product.
- Make sure that no foreign matter enters inside the mesh part of the product. Performance may be degraded.
- For important recordings, perform a trial recording beforehand to make sure that the sound is recorded correctly.
- Audio-Technica will not be liable in any way for any loss data or damage connected to the product.

Part names and functions

Microphone

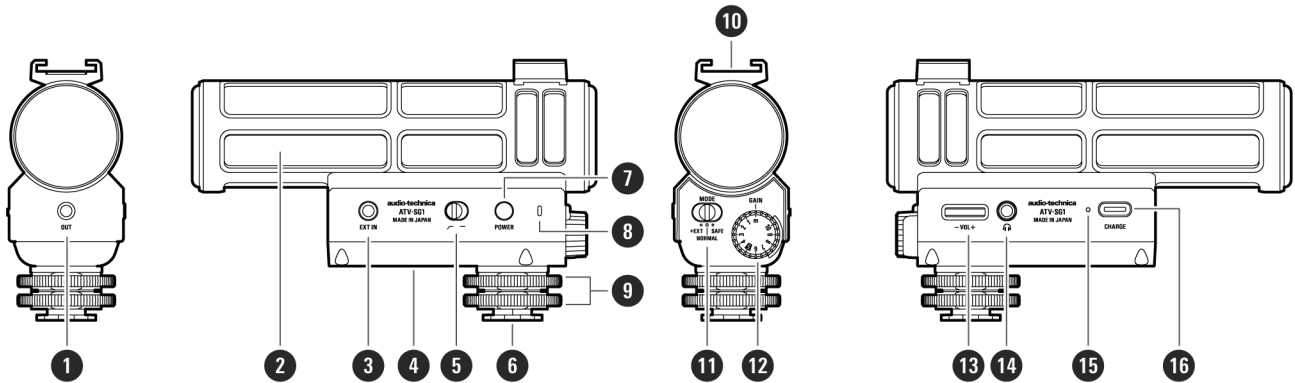

- ❶ Output terminal (3.5 mm (1/8") stereo mini-jack)
- ❷ Microphone
- ❸ External microphone input terminal (3.5 mm (1/8") stereo mini-jack)

External microphones, such as commercially available wireless lavalier microphones can be connected to this terminal. The terminal provides plug-in power for compatible microphones. When the output mode is set to "+EXT," the audio signal input to this terminal will be output from the right channel of the product.

- ❹ Slide rail

Adjust the mounting position of the product relative to the camera.

- ❺ Low-cut filter switch

Turn the low-cut filter ON or OFF. When set to ON, this reduces the low-frequency range of the product's audio output signal. If you are bothered by unwanted air conditioning noise, vibration, or wind noise, turn the switch ON.

- ❻ Shoe mount plate

Attaches to the camera's accessory shoe. There is also a 1/4" threaded hole on the bottom, allowing it to be mounted on a tripod or other stand.

- ❼ Power supply button

Press and hold the button (for about 1 second) to turn the power ON and OFF.

- ❽ Indicator lamp

The status of the product is indicated by continuous or flashing colored illumination.

- ❾ Lock rings

The upper ring is for the slide rail. The lower ring is for the camera's accessory shoe.

- ❿ Accessory Shoe

You can attach a commercially available wireless lavalier microphone.

- ⓫ Output mode selector switch

Switch the output mode.

- ⓬ Output gain control knob

Adjust the output level.

⑬ Headphone level control dial

Adjust volume of headphone output.

⑭ Headphone output terminal (3.5 mm (1/8") stereo mini-jack)

Connect headphones to monitor the audio output signal of the product.

⑮ Firmware reset button

While the product is charging, press and hold (for about 1 second) the button to reset the firmware.

⑯ USB terminal (USB Type-C™)

Use to connect the included USB charging cable and charge the product. The USB terminal is for charging only. The product cannot be used as a USB microphone.

Included accessories

①

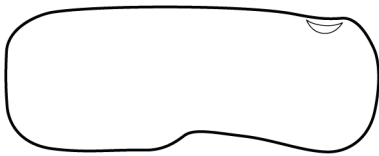

②

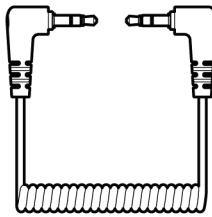

③

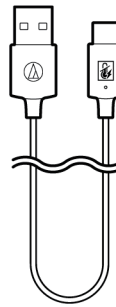

① Wind muff (exclusive for ATV-SG1)

② Coiled cable (approx. 5 cm (2.0") (when extended: approx. 50 cm (20")), 3.5 mm (1/8") stereo mini-plug × 2)

③ USB charging cable (50 cm (20"), USB Type-A to USB Type-C)

The USB charging cable is equipped with an overheat protection function.

Indicator lamp display

Indicator lamp	Description
Lights in blue	Power is ON (battery level is sufficient)
Lights in yellow	Power is ON (Continuous operating time: approx. 4 hours remaining ^[1] (when headphone monitor is not in use))
Flashing red	Power is ON (Continuous operating time: approx. 1.5 hours remaining ^[1] (when headphone monitor is not in use))
Flashing green	Charging
Flashing blue	Charging (with the power turned on)
Off	Charging complete Power is OFF
The light flashes pink, then turns off	Firmware reset
Flashing red and green	Abnormal temperature condition ^[2]

[1] These figures are approximate. This varies depending on the usage environment.

[2] The product is hot. Stop charging or using the product, wait for it to cool down, and then resume use.

Operating temperature range: 0°C to 40°C (32°F to 104°F)

Charging temperature range: 10°C to 35°C (50°F to 95°F)

Charging the battery

- Fully charge the battery when using for the first time.
- When the rechargeable battery is running low, the indicator lamp changes from blue to yellow to flashing red. If the indicator lamp flashes red, charge the battery as soon as possible.
- It takes about 2.5 hours maximum to charge the battery fully. (This time may vary depending on usage conditions.)
- Charge the product in a well-ventilated place (10 to 35°C (50 to 95°F)) away from direct sunlight. Charging outside the normal charging temperature range may result in failure to charge or longer charging time. In addition, the battery may deteriorate, possibly resulting in shorter periods of continuous use or failure to charge.

1 Connect the included USB charging cable (USB Type-C side) to the USB port of the product.

- The included USB charging cable is designed for exclusive use with the product. Do not use any other USB cable.
- When plugging the USB charging cable into the USB port, insert it straight (horizontally).

2 Connect the included USB charging cable (USB Type-A side) with a standard USB power adapter, and plug it into a household electrical outlet.

- USB power adapter is not included with this product. Purchase a USB power adapter that supports 5 V / 1 A or higher.
- While charging, the indicator lamp flashes as follows.

Indicator lamp	Description
Flashing green	Charging
Flashing blue	Charging (with the power turned on)
Off	Charging complete

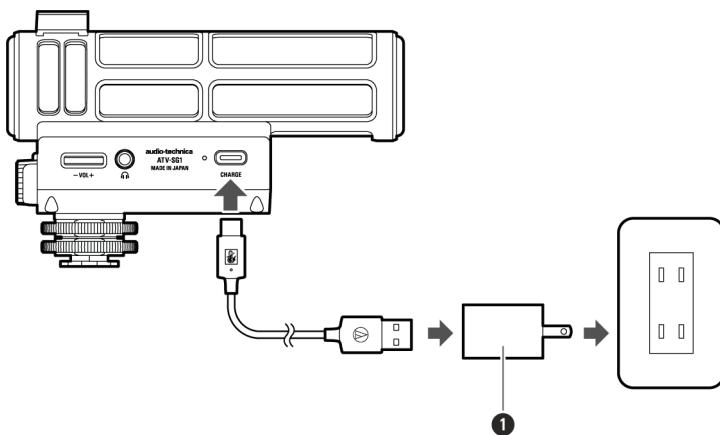

1 USB power adapter (commercially available)

3 Once charging is complete, unplug the USB power adapter from the household outlet, and disconnect the USB charging cable (USB Type-A side) from the USB power adapter.

4 Remove the USB charging cable (USB Type-C side) from the USB port of the product.

Caution

- The included USB charging cable is equipped with an overheat protection function. Charging will stop if abnormal heat generation is detected due to charging being performed with water or foreign matter inside the UAB port of the product or USB charging cable. To prevent electric shock or malfunctions due to reasons such as heat generation, smoke emission and fire, make sure to use the included USB charging cable when charging the product.
- The product may not charge with cables other than the included USB charging cable.

Using the product while charging

The product can be used while charging. It's convenient to use a commercially available power bank.

Caution

- Be aware of the product overheating.
- If you use the product while charging it with a USB power adapter (sold separately), you may experience some noise.

Attaching the wind muff

- To reduce wind noise when using the microphone outdoors, attach the included wind muff to the microphone body.
- The included wind muff is designed exclusively for ATV-SG1.

- 1** Place the wind muff over the microphone body and attach it so that the accessory shoe protrudes from the hole at the top.

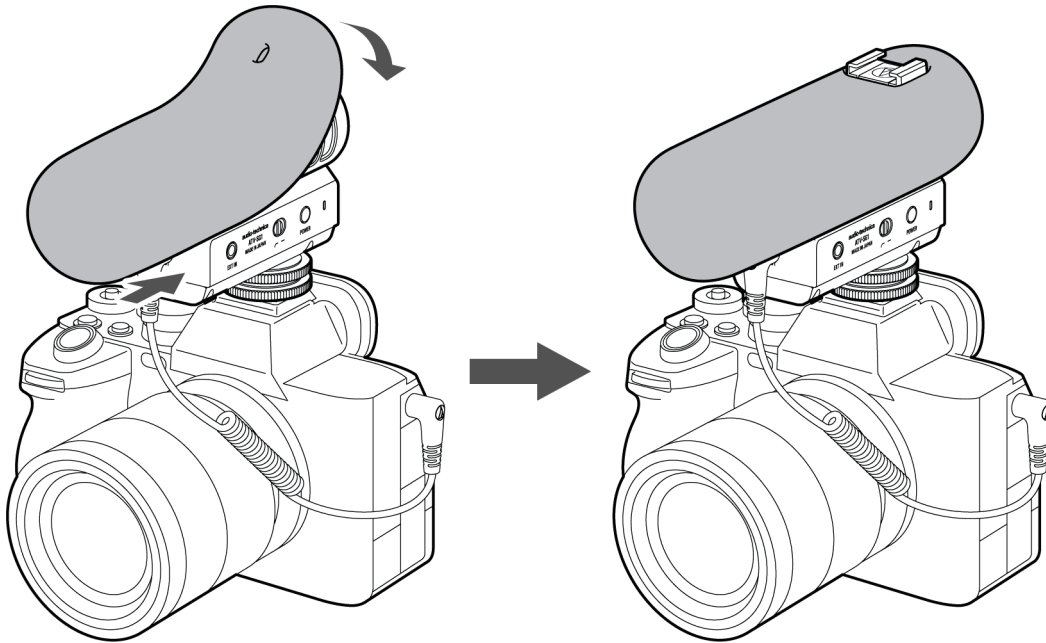

Connection procedure

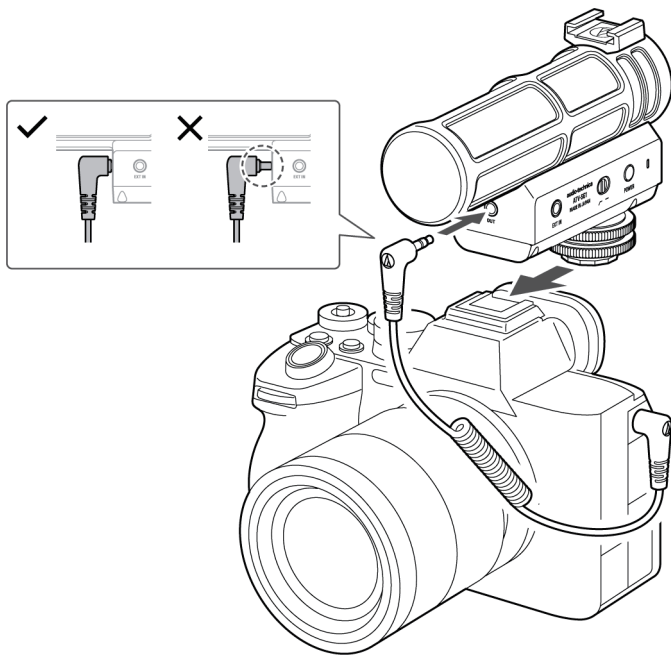

- 1** Loosen the lock ring on the product, insert the shoe mount plate into the camera, and then turn the lower lock ring to secure it to the camera.
 - The shoe mount plate has 12 positions, allowing you to adjust the microphone's angle in 30-degree increments. To ensure optimal performance, position the microphone so that the sound source is directly in front of it.
- 2** After attaching the product to the camera, turn the upper lock ring to use the slide rail and adjust the position of the product forward or backward.
 - This prevents the product from appearing in the frame and prevents interference between accessories.

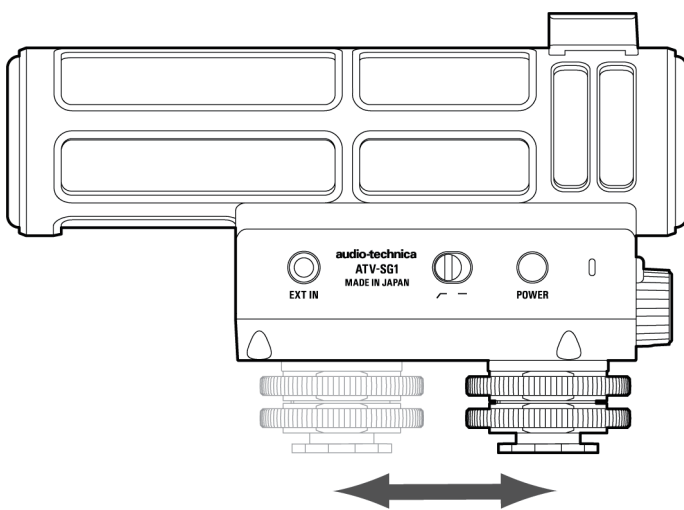

- 3** Connect the included coiled cable to the output terminal of the product and the microphone input terminal of the camera.
 - Make sure that the coiled cable is attached securely.

To adjust the orientation of the product

This product's shoe mount plate has 12 positions and can be adjusted in 30-degree increments. To ensure optimal performance, position the microphone so that the sound source is directly in front of it.

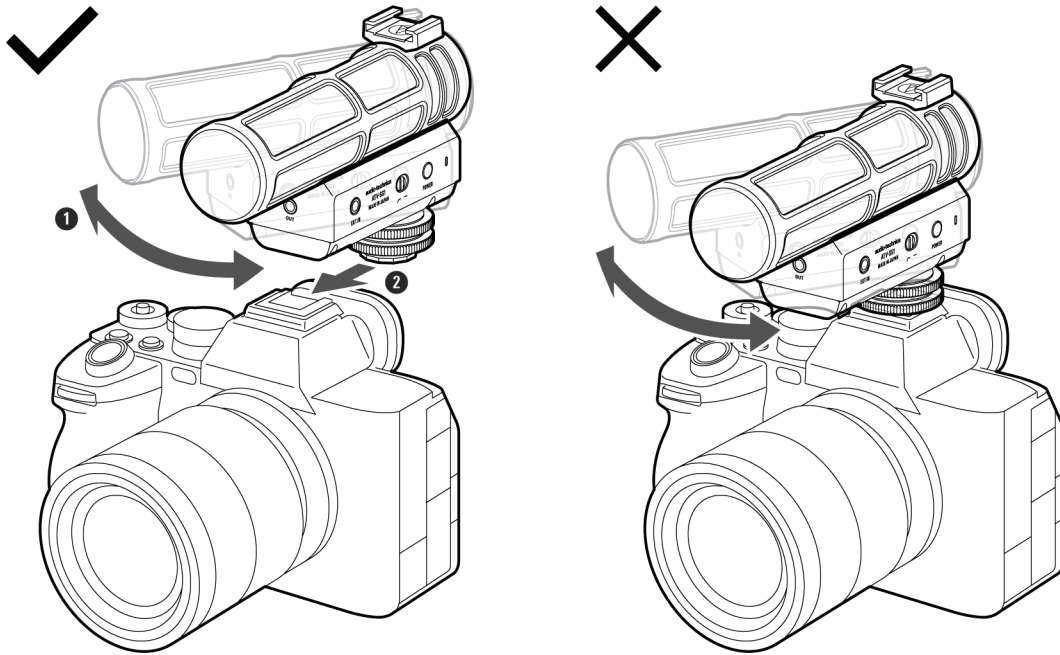

Caution

- When reorienting the product, be sure to remove the shoe mount plate from the camera's accessory shoe, reorient it, and then reattach it.
- If you attempt to forcefully reorient the product while it is attached to the camera's accessory shoe, you may damage the product or the interior of the camera's accessory shoe. Adjust the orientation following the correct procedure.

Basic usage

- 1 Set the output mode selector switch to “NORMAL” and start by setting the output gain control knob to “5”.
 - Unless you have made any specific adjustments to your camera settings, we recommend using this setting.
 - First, try recording with these settings, and then adjust them to suit your environment and camera settings.

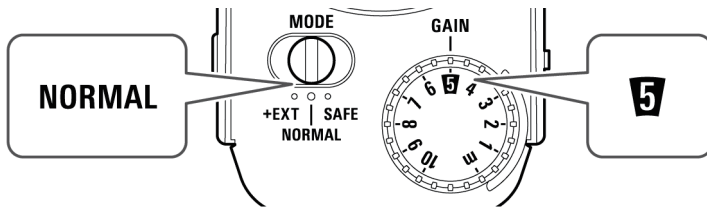

- 2 Turn on the camera.
 - If the camera's microphone input supports plug-in power, turning on the camera will automatically turn on the product as well.
 - If the product does not turn on even after you turn on the camera, check the camera settings. Depending on your camera, you may be able to turn the plug-in power on or off.
 - You can also manually turn the power on or off by pressing and holding (for about 1 second) the power supply button of the product.

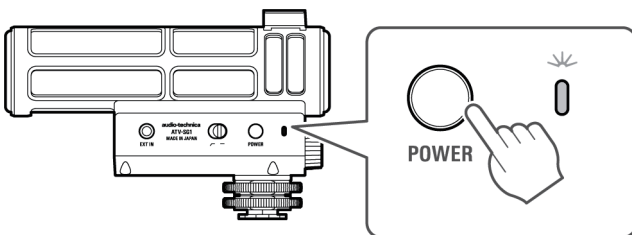

» The power turns on and the indicator lamp lights in blue.

- 3 Operate the camera and record.

Function description

Output gain (GAIN)

Check the camera's audio level meter and adjust the setting so that the sound doesn't distort. Adjust the gain by turning the output gain control knob left or right.

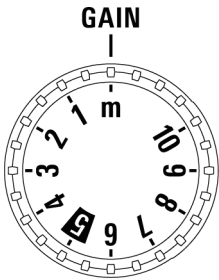

Caution

- If your camera has a gain setting, check and adjust the setting on the camera.
- If you haven't adjusted your camera setting, start by setting the gain to 5, then adjust it according to your recording environment and camera setting.

Output mode (MODE)

You can switch the output mode to suit your recording environment.

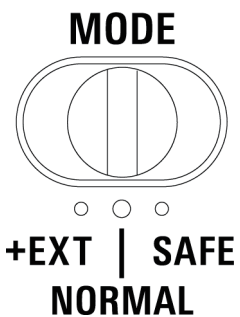

Mode	Description
+EXT	Use this mode when connecting to an external microphone, such as a commercially available wireless lavalier microphone, using the external microphone input terminal. The input audio signal is output from the R channel of the product. This product and the lavalier microphone's audio can be recorded simultaneously with the camera, and the recordings can be replaced or mixed during editing. ^[1]
NORMAL	Select this mode for normal use.
SAFE	Select this mode when using the safety track function. The safety track function simultaneously records audio at a volume 6 dB lower than the normal volume (main) on the camera's R channel. Even if clipping on the normal track due to loud noises or sudden sounds, you can replace the affected sections with the lower-volume version during editing, effectively creating a high-quality backup.

[1] Audio signal input through the external microphone input terminal is not affected by the product's gain setting. When adjusting the output level, do so on the external microphone.

Caution • Even when using the safety track function, it may not be able to correct distortion depending on the volume of the sound or noise.

Low-cut filter

It reduces low-frequency noise such as wind, traffic, and air conditioning. If you are concerned about low-frequency noise, turn on the low-cut filter.

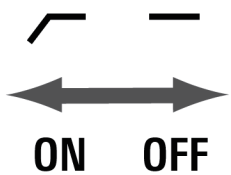
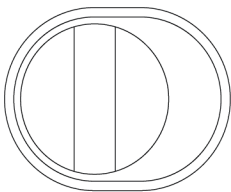

Other usage

Connect headphones to monitor

You can connect headphones to the headphone output terminal to monitor the product's audio in real time.

- 1 Connect the headphones to the headphone output terminal.

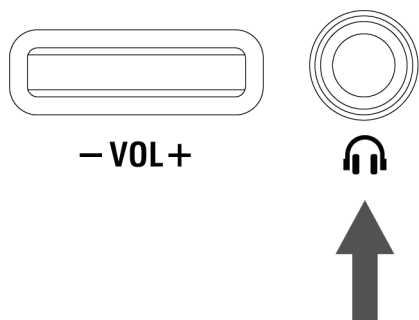

- 2 Turn the headphone level control dial to adjust the volume.

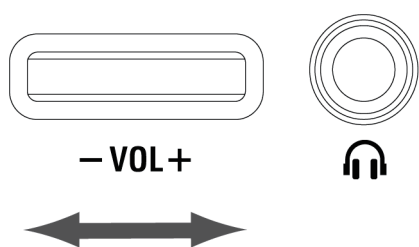

Note

- The headphone level control dial adjusts the volume of the headphone output. This does not affect the actual output.

Connecting and using the wireless lavalier microphone

You can use the product by connecting to a commercially available wireless lavalier microphone using the external microphone input terminal. The input audio signal is output from the R channel of the product. This product and the lavalier microphone's audio can be recorded simultaneously with the camera, and the recordings can be replaced or mixed during editing.

- You can also connect a wired lavalier microphone with a plug-in power system to the external microphone input terminal.

- 1** Attach the wireless lavalier microphone receiver to the accessory shoe.
- 2** Connect the external microphone input terminal to the output terminal of the wireless lavalier microphone receiver.
- 3** Set the output mode selector switch to "+EXT".

Note

- By attaching a wireless lavalier microphone transmitter and connecting the output terminal of the product to the input terminal of the transmitter, the product can be used as a wireless shotgun microphone. In this case, set the output mode to "NORMAL".
-

Caution

- Do not attach excessively heavy items to the accessory shoe.
-

Cleaning

Get into the habit of regularly cleaning the product to ensure that it will last for a long time. Do not use alcohol, paint thinners, or other solvents for cleaning purposes.

- Use a dry cloth to clean the microphone body.
- If the cable becomes dirty because of sweat, etc., wipe it with a dry cloth immediately after use. Failure to clean the cable may cause it to deteriorate and harden over time, possibly resulting in malfunction.

Caution

- If the product will not be used for an extended period of time, store it in a well-ventilated place free from high temperatures and humidity.
-

If this product is not functioning properly (firmware reset)

If a problem occurs, such as the product not turning on, perform a firmware reset.

- 1 While the product is charging, press and hold the firmware reset button (for about 1 second) using a thin pin or similar object.

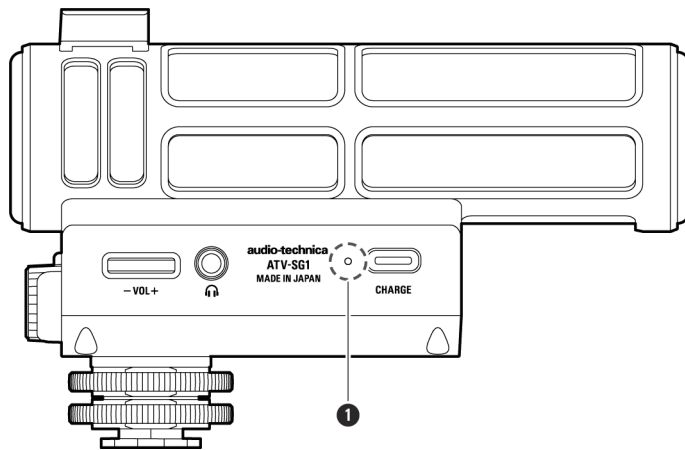

- 1 Firmware reset button

» The indicator lamp will flash pink and then turn off, signaling that the firmware reset is complete.

Caution

- If the product continues to malfunction even after performing a firmware reset, stop using the product and contact your local Audio-Technica dealer for repairs.

About battery replacement

The battery in the product can be replaced, but in some countries or regions it may not be possible for customers to replace the battery on their own. In such cases, contact your local Audio-Technica dealer for battery replacement.

- Use an Audio-Technica battery, (sold separately). If battery is not available for sale in your country or region, contact your local Audio-Technica dealer for battery replacement.
- The product is a precision instrument. Replace battery with extreme care.
- Do not lose the screws when replacing battery.
- Do not drop or damage the removed battery. Dispose of the removed battery properly in accordance with local laws and regulations. If you have any questions, contact your local Audio-Technica dealer.
- Replace battery at your own risk. Note that if the product malfunctions due to improper installation by the customer, it will not be covered by the warranty (and we cannot be held liable).

- 1** Loosen the four screws on the bottom of the product and remove them.

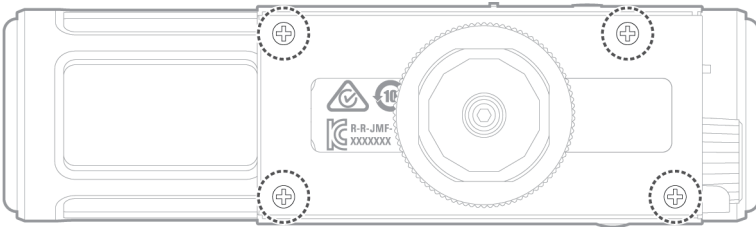

- 2** Remove the bottom case and disconnect the rechargeable battery cable plug from the product.

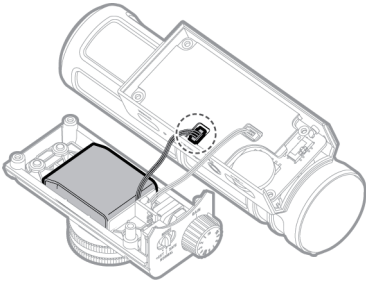

- 3** Remove the rechargeable battery from the product.

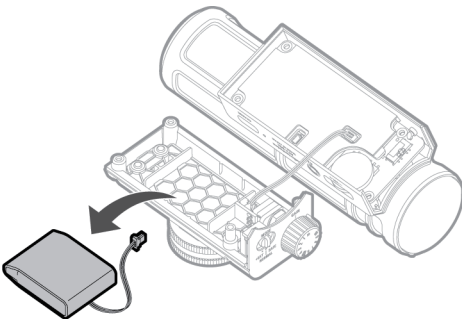

- 4** Place the new rechargeable battery in the same position as the original.

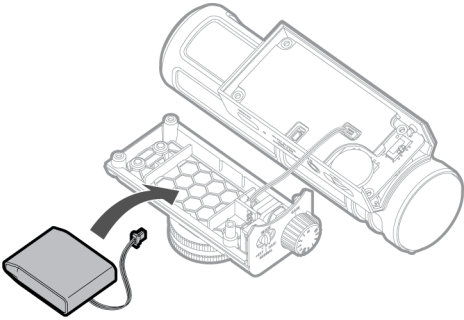

- 5** Attach the rechargeable battery cable plug to the product, attach the bottom case, and tighten the screws securely.

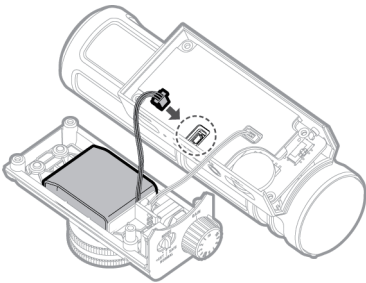

Dimensions

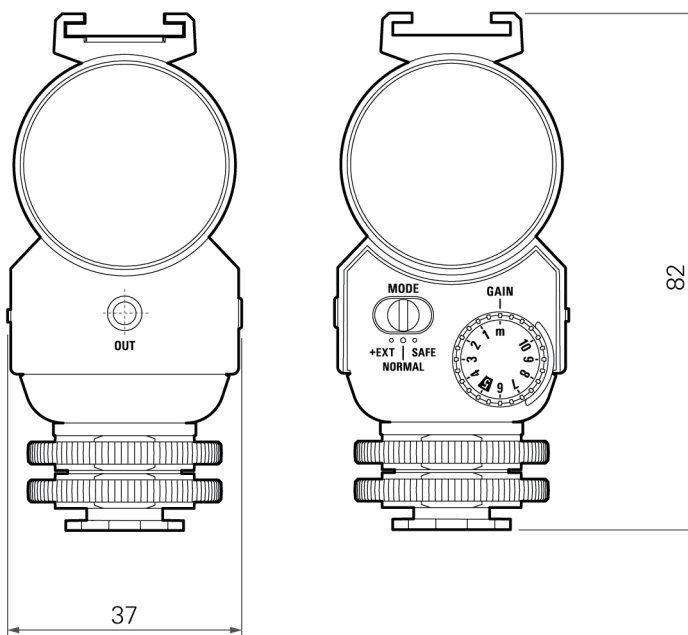
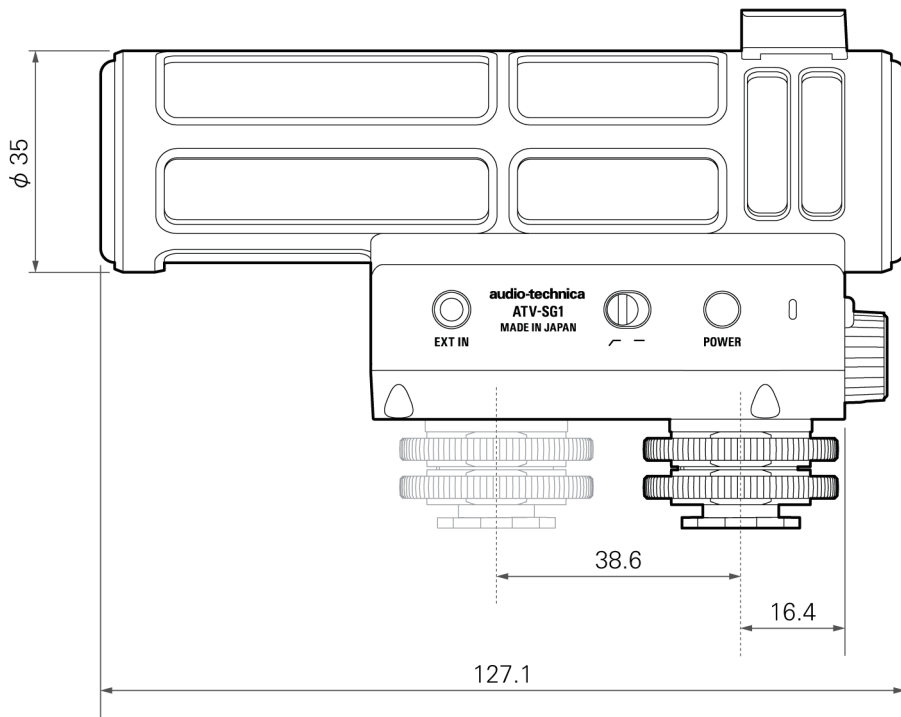

(Unit: mm)

Specifications

Microphone

Element	Fixed-charge back plate, permanently polarized condenser
Polar pattern	Line + gradient
Frequency response	60 to 20,000 Hz
Low cut	160 Hz, 24 dB/octave
Open circuit sensitivity	-28 dBV (maximum gain) -35 dBV (gain setting: 5)
Gain range	37 dB (stepless)
Maximum input sound level	126 dB SPL (1 kHz, THD 3%) (maximum gain) 132 dB SPL (1kHz THD 3%) (minimum gain)
Dynamic range	109 dB (1 kHz, THD 3%) (maximum gain)
Signal-to-noise ratio	77 dB (1 kHz at 1 Pa, A-weighted) (maximum gain)

Main output

Output terminal	3.5 mm (1/8") stereo mini-jack
-----------------	--------------------------------

Headphone output

Supported headphone impedance	Minimum 16 ohms
Output level	100 mW (at 1kHz, 32 ohms load) 75 mW (at 1kHz, 16 ohms load)
Total harmonic distortion	< 1% (at 60 mW, 1 kHz, 32 ohms output)

External input

Input terminal	3.5 mm (1/8") stereo mini-jack (input audio is mixed to mono)
External power supply	Plug-in power (2.7 V)

Other

Power supply	DC 3.85 V lithium ion battery
Charging time	Approx. 2.5 hours
Operating time	Max. approx. 24 hours (when not using the headphone monitor)
Operating temperature range	0°C to 40°C (32°F to 104°F)
Storage temperature range	-10°C (14°F) to 60°C (140°F), 10% to 90% RH (without condensation)
Weight	Approx. 155 g (5.5 oz)
Dimensions	127.1 mm (5.0") long 35 mm (1.4") maximum body diameter (microphone) 82 mm (3.2") height
Included accessories	Coiled cable (approx. 5 cm (2.0") (when extended: approx. 50 cm (20")), 3.5 mm (1/8") stereo mini-plug × 2), USB charging cable (50 cm (20")), USB Type-A to USB Type-C), Wind muff (exclusive for ATV-SG1)

- For product improvement, the product is subject to modification without notice.

Polar pattern/Frequency response

Polar pattern

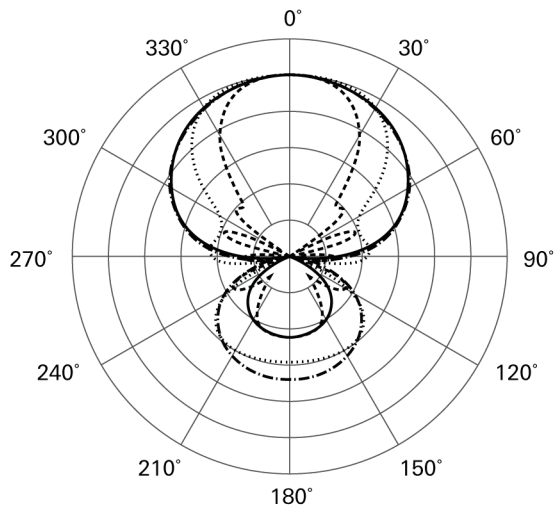

LEGEND

-----	200 Hz	SCALE IS 5 DECIBELS PER DIVISION
————	1 kHz	
.....	5 kHz	
-----	8 kHz	

Frequency response

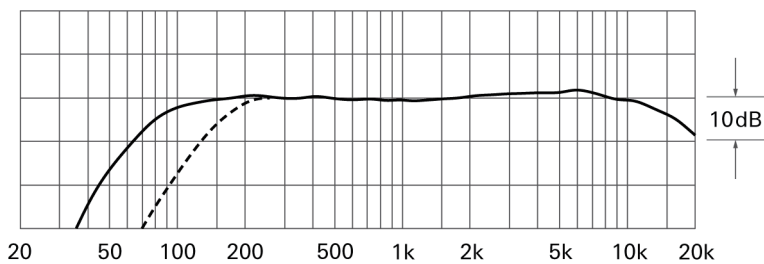

LEGEND

————	0°, 50 cm
-----	0°, 50 cm, Low cut

Trademarks

- USB Type-C™ is a trademark of USB Implementers Forum.

株式会社オーディオテクニカ

〒194-8666 東京都町田市西成瀬2-46-1
www.audio-technica.co.jp

Audio-Technica Corporation

2-46-1 Nishi-naruse, Machida, Tokyo 194-8666, Japan
www.audio-technica.com
©2026 Audio-Technica Corporation
Global Support Contact: www.at-globalsupport.com